

HDPE FABRICATION & HDPE PIPE WELDING

SPECIALIZING IN LANDFILL PRODUCTS & DESIGN

BUILT TO LAST!!

KENT IMEL

CCB# 252996

541-973-6967

KENT@KI-POLY.COM

EASY SEAL !!

EMISSIONS CONTROL SYSTEM

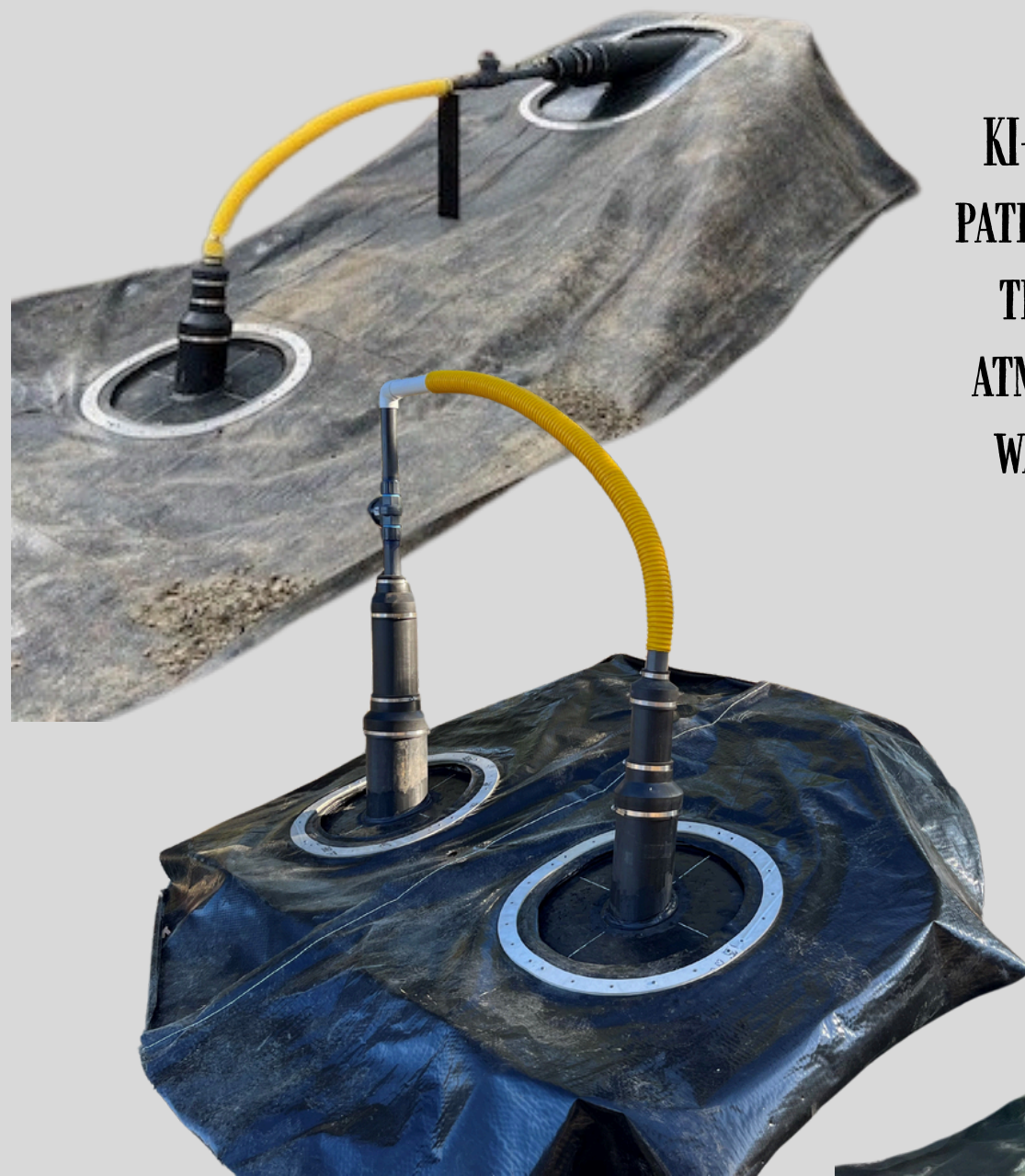

**KI-POLY FUSION HAS DESIGNED & FABRICATED A
PATENT PENDING, EASY TO INSTALL, SOLUTION FOR
THE RELEASE OF HARMFUL EMISSIONS TO THE
ATMOSPHERE, AND OXYGEN INTRUSION INTO THE
WASTE MASS AT ALL LANDFILL PENETRATIONS**

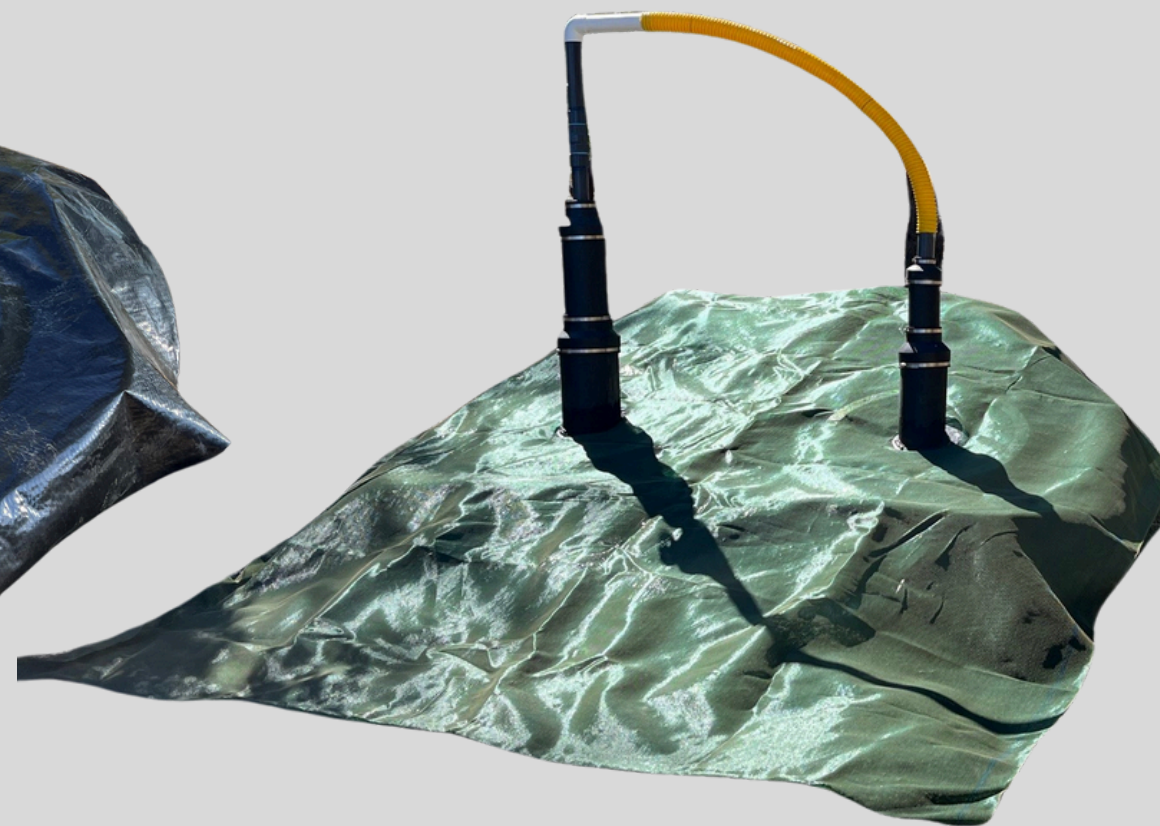

FEATURES

- **FABRICATED TO ANY SLOPE ANGLE OR SIZE OF PENETRATION**
- **FABRICATED FOR ALL APPLICATIONS VERTICAL, HORIZONTAL OR DECK**
- **CONSTRUCTED OUT OF DURABLE HDPE**
- **IMPERMEABLE BATTEN SYSTEM SEALS TEMP COVER SYSTEM TO BASE**
- **HDPE BASE ALLOWS EXTRUSION WELDING FOR FINAL CLOSURE SYSTEM**
- **RESISTS HARMFUL UV RAYS & INCLEMENT WEATHER**
- **GROUND ANCHORS ON BASE TO PREVENT LIFT OR SHIFTING**

BENEFITS

- **LIMITS OXYGEN INTRUSION & EMISSIONS RELEASE AT LANDFILL
SURFACE PENETRATIONS**
- **CAN BE REUSED FROM TEMPORARY COVER TO FINAL CLOSURE
APPLICATION**
- **REUSED FROM ONE WELL TO THE NEXT DUE TO ABANDONED WELLS**
- **LIMITS EXCEEDANCES DURING EMISSIONS MONITORING**
- **RESISTS ANY AMOUNT OF SETTLEMENT AT LANDFILL SURFACE WITHOUT
RIPPING OR TEARING**
- **EASY TO INSTALL**
- **SHOULD LAST THE LIFE OF THE LANDFILL**
- **LIMITS UNNECESSARY COST OF REPAIRS TO EXISTING SYSTEMS/BOOTS**
- **AESTHETICS, GIVES THE LANDFILL A PROFESSIONAL LOOK**

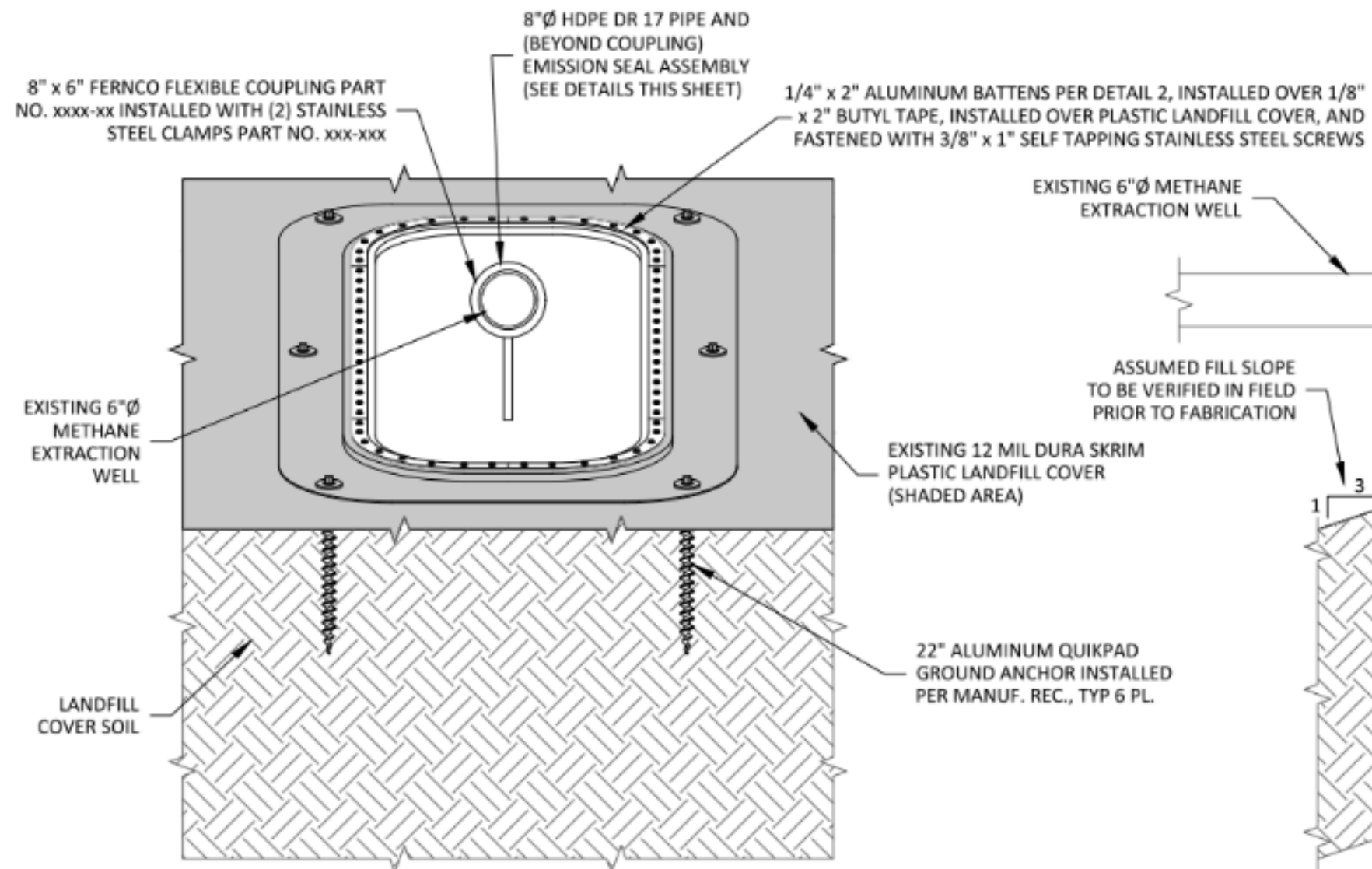

INSTALL END ELEVATION

LANDFILL PENETRATION EMISSION SEAL

3/4"=1'-0"

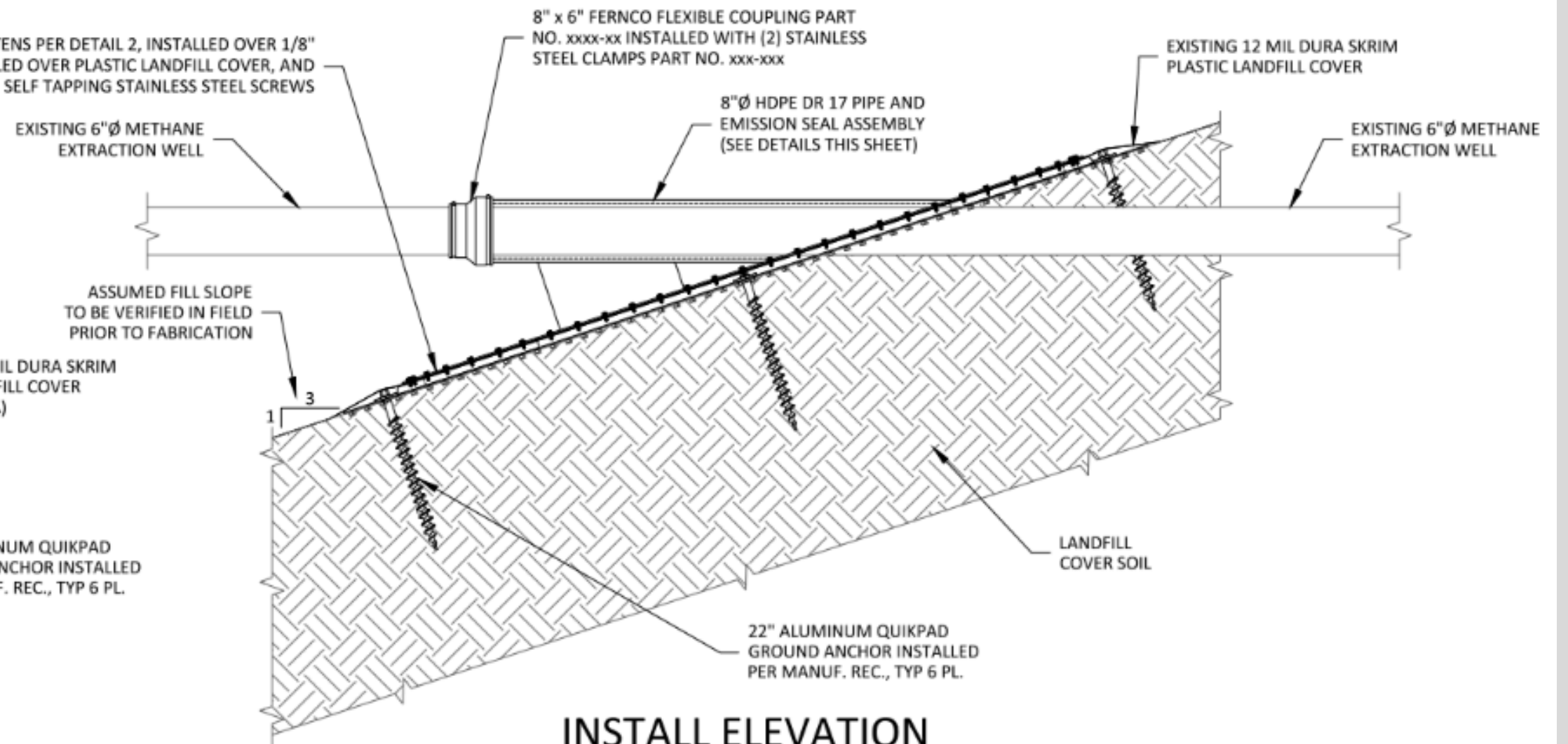

INSTALL ELEVATION

LANDFILL PENETRATION EMISSION SEAL

3/4"=1'-0"

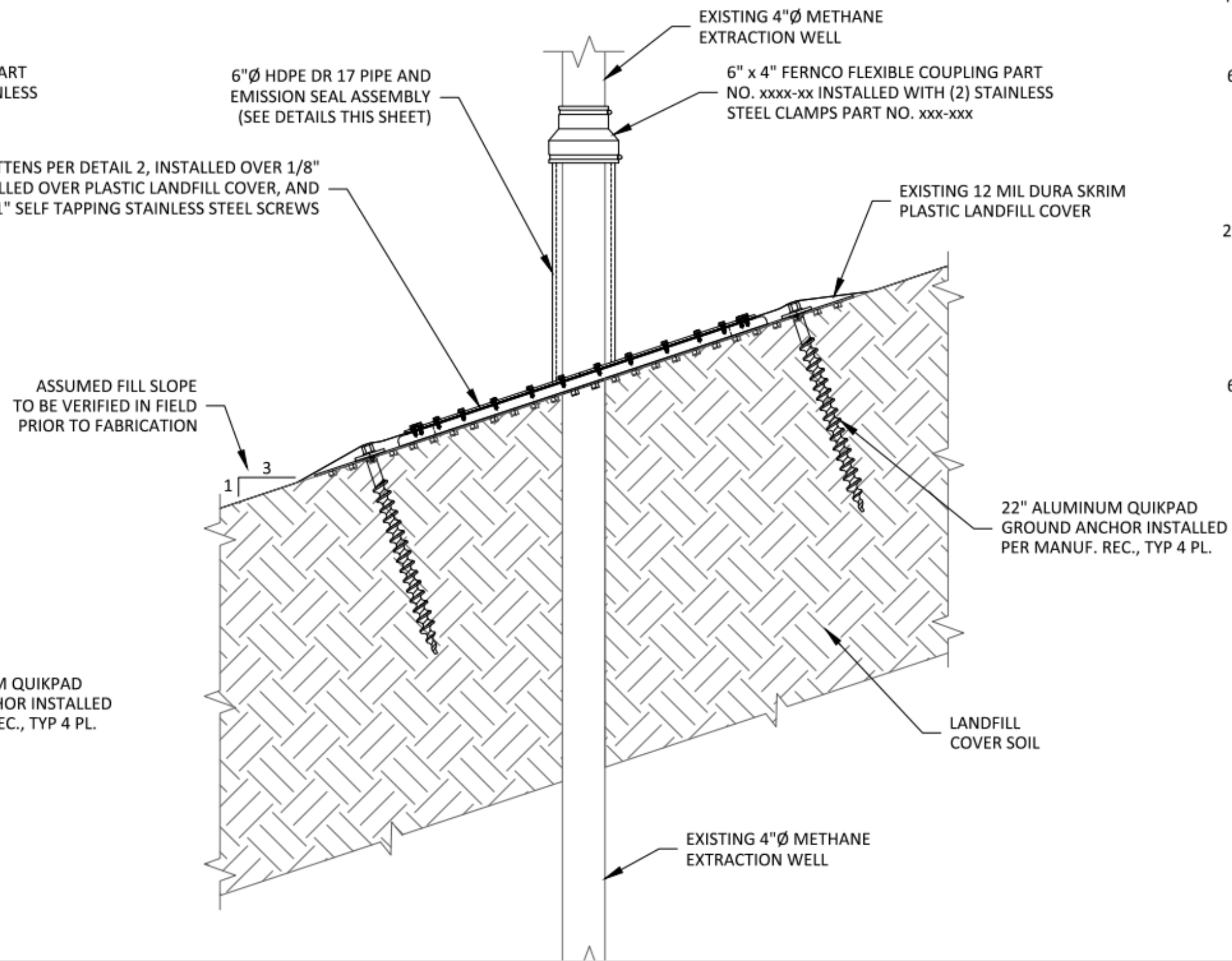
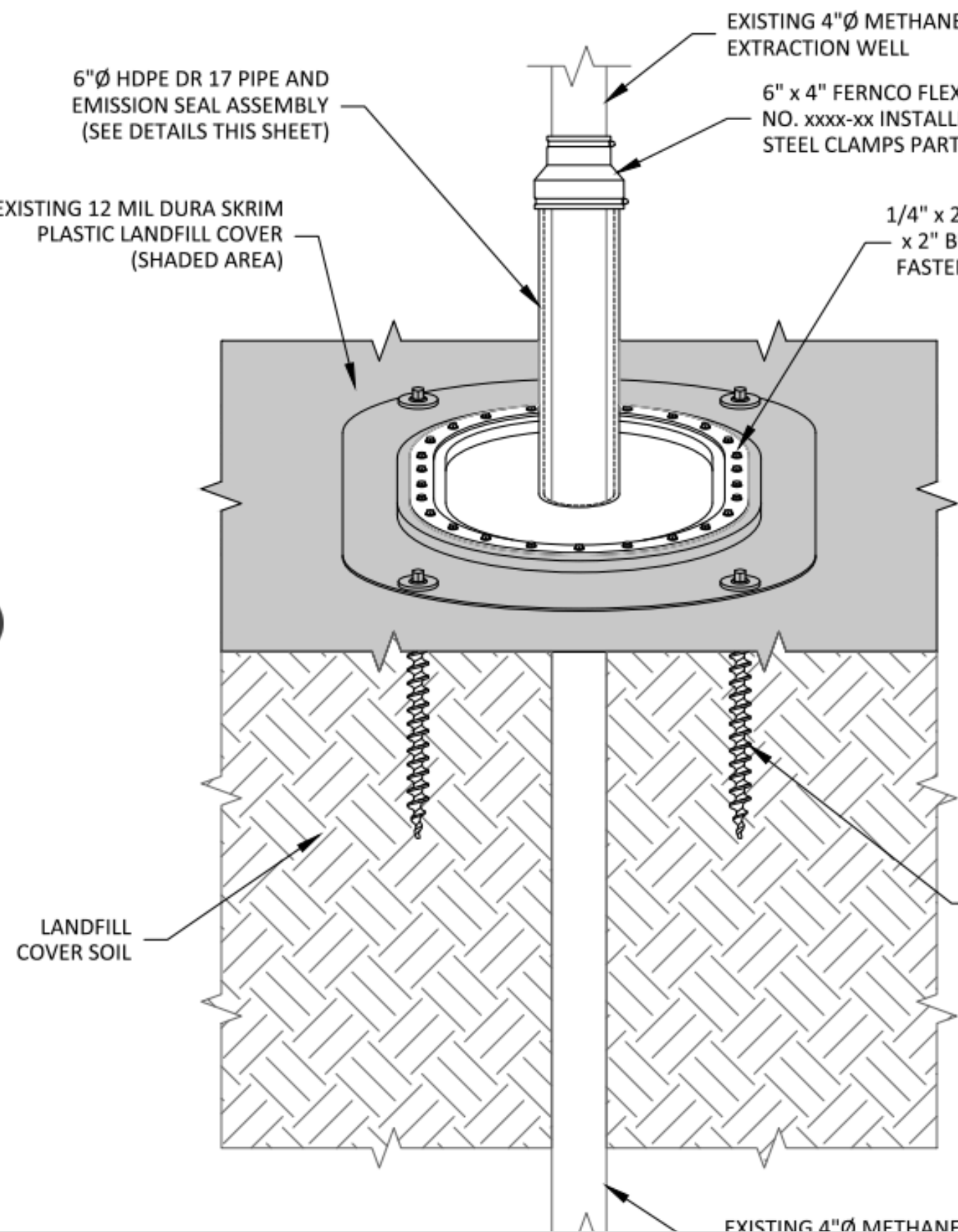

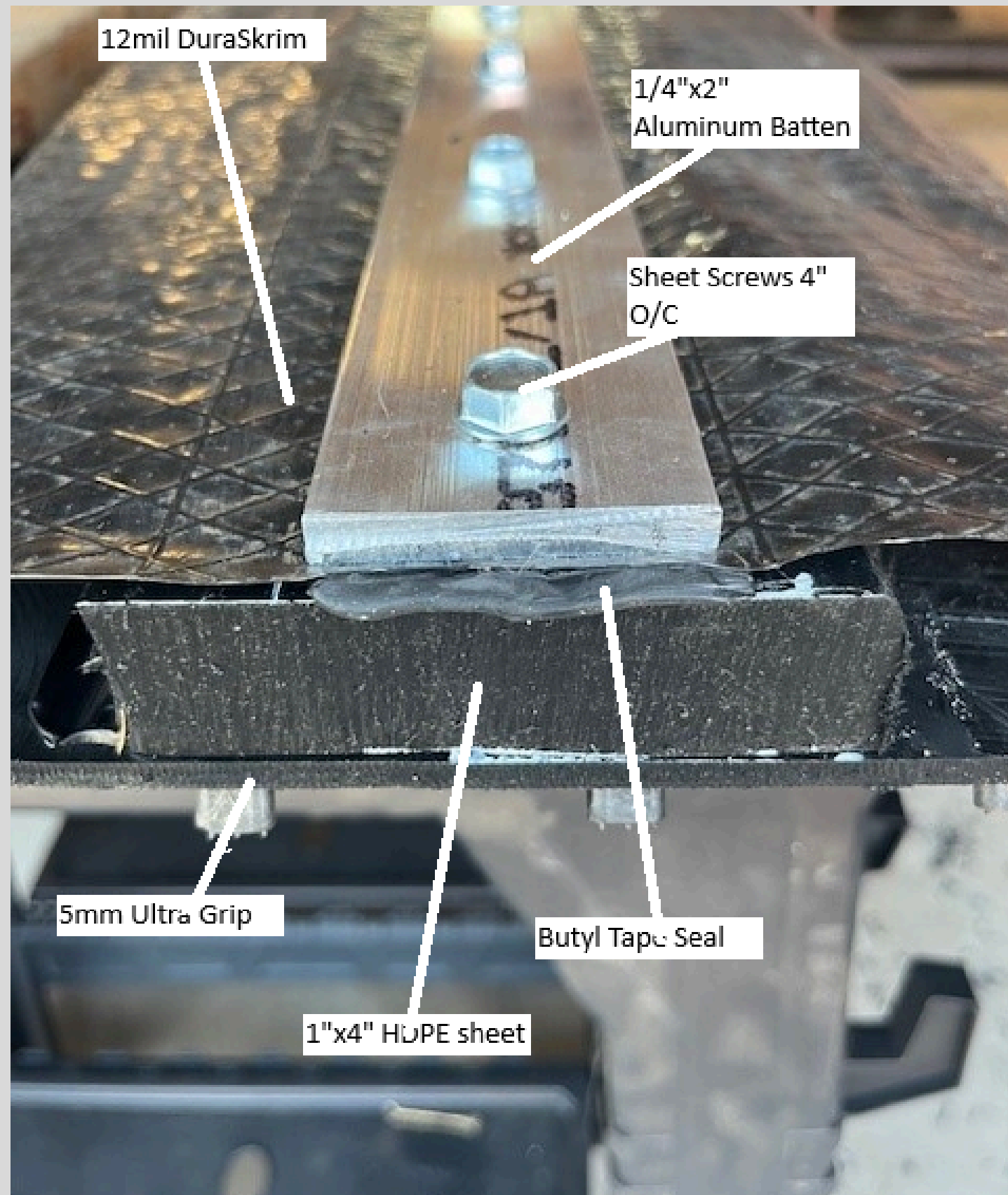

PROFILE VIEW OF THE EASY SEAL STRIP & BATTEN SYSTEM

- THIS IS A PROFILE VIEW OF THE SEALS BATTEN SYSTEM THAT PROVIDES THE SEAL FROM THE TEMP COVER SYSTEM TO THE EASY SEAL BASE.
- BASE MATERIAL IS CONSTRUCTED OUT OF HDPE AGRU 5MM ULTRA GRIP, THIS MATERIAL WILL SETTLE IN THE GROUND TO ASSIST SEAL FROM SHIFTING AND PROVIDES A HEAVY DUTY BASE FOR EXTRUSION WELDING TOO.
- 4"x1" SHEET (SEAL STRIP) ALLOWS MATERIAL FOR SCREWS TO BITE, CREATING PRESSURE ON THE TEMP PLASTIC MATERIAL. SEAL STRIP IS EXTRUSION WELDED TO THE BASE INSIDE AND OUT.
- BUTYL TAPE IS PLACED BETWEEN THE BASE AND TEMP COVER TO CREATE AN RESISTANT SEAL THAT LIMITS EMISSIONS FROM LEAVING THE SURFACE OF THE LANDFILL.
- 2" x 1/4" BATTON STRAP PROVIDES EQUAL PRESSURE SURROUNDING THE ENTIRE PENETRATION AGAINST SEAL STRIP.



FINAL CLOSURE APPLICATION

- **IF YOU ARE USING THE EASY SEAL FOR A FINAL CLOSURE APPLICATION THE BATTEN SEAL STRIP IS NOT NECESSARY AND THE FINAL CLOSURE MATERIAL LINER SYSTEM CAN BE EXTRUSION WELDED DIRECTLY TO THE BASE MATERIAL.**
- **IF YOU ARE SWITCHING FROM A TEMP COVER SYSTEM TO A FINAL CLOSURE THE SEAL CAN BE REUSED AND THE FINAL COVER CAN STILL BE EXTRUSION WELDED TO THE BASE.**

ANCHORS

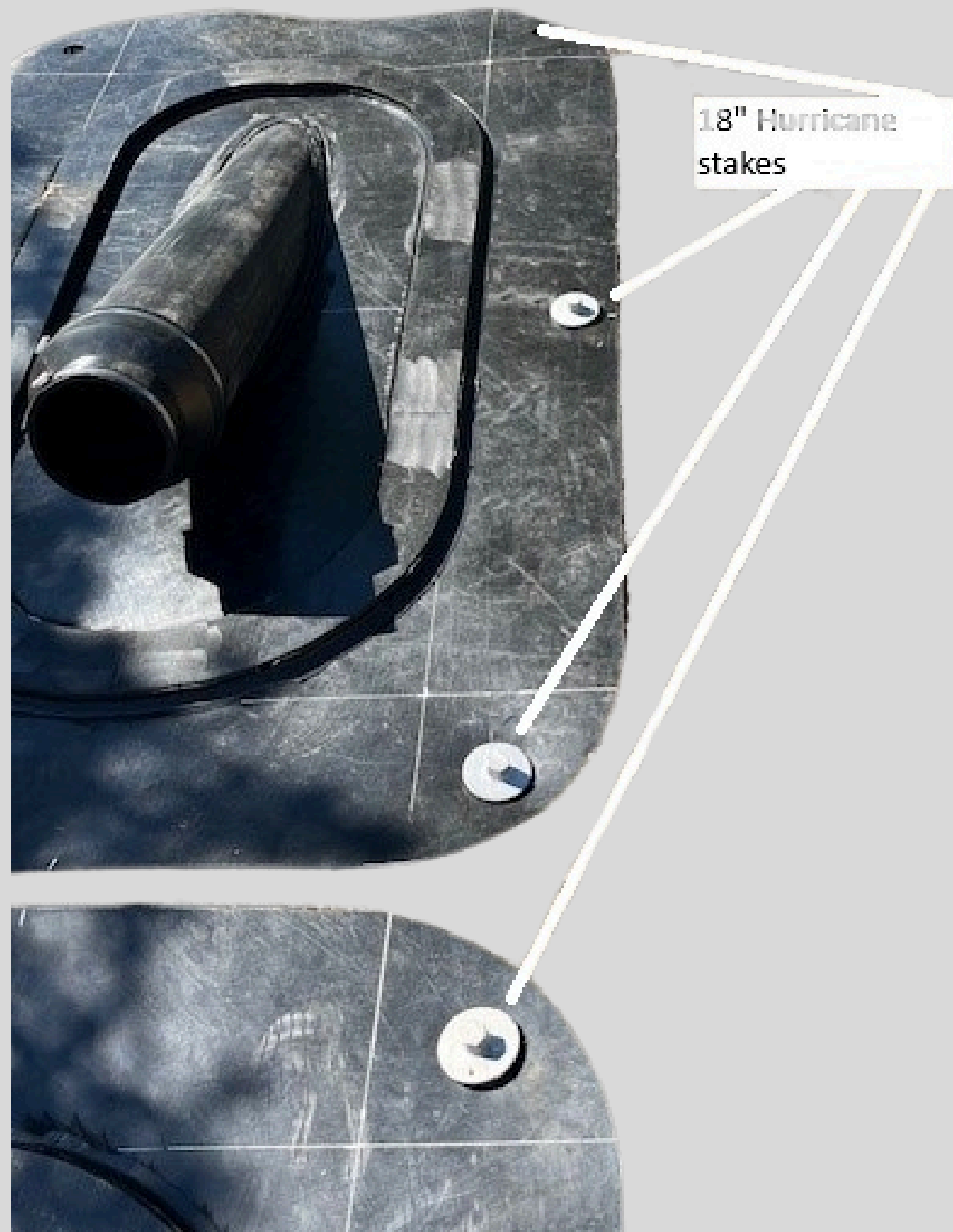

- **ONCE THE SEAL HAS BEEN PLACED OVER THE EXISTING WELL 18" ANCHORS ARE PLACED THROUGH PREDRILLED HOLES TO PREVENT LIFT AND SHIFTING OF THE SEAL.**
- **IN A VERTICAL APPLICATION THE ANCHORS ALSO ASSIST WITH SETTLEMENT, DRAWING THE SEAL DOWN WITH THE SOIL WITHOUT RIPPING OR TEARING, ALLOWING THE FERNCO TO SLIP DOWN THE PENETRATION.**
- **IN A FINAL CLOSURE APPLICATION THE ANCHORS WILL NOT BE USED AS THE SEAL WILL BE EXTRUSION WELDED TO FINAL COVER AND THE ENTIRE BASE OF THE SEAL WILL BE COVERED WITH SOIL LEAVING A SHORT SECTION OF PIPE AND FERNCO ABOVE GROUND FOR SETTLEMENT ADJUSTMENT .**

DUAL USE, LONG RADIUS AND SETTLEMENT

- **THIS EXAMPLE SHOWS THE DUAL USE OF THE EASY SEAL**
- **ON THE RIGHT SIDE YOU CAN SEE WHERE THE SEAL MAY BE USED IN A TEMPORARY COVER APPLICATION WITH THE BATTEN SYSTEM.**
- **ON THE LEFT SIDE YOU CAN SEE WHERE THE FINAL COVER LINER CAN BE TACKED AND EXTRUSION WELDED DIRECTLY TO THE BASE MATERIAL.**
- **THE LONG RADIUS AROUND ALL THE PENETRATIONS (NO CORNERS) RESIST RIPPING OR TEARING WHEN MATERIAL TENDS TO LIFT IN WIND OR OTHER POOR WEATHER.**
- **THE FERNCO AT THE END OF ALL THE PENETRATION SLEEVES ALLOWS FOR SETTLEMENT AT THE LANDFILL SURFACE, SIMPLY LOOSEN THE THE UPPER CLAMP AGAINST THE PENETRATION WHEN STRESS IS OBSERVED DURING MONTHLY MONITORING AND ALLOW SLIPPAGE AND RETIGHTEN.**

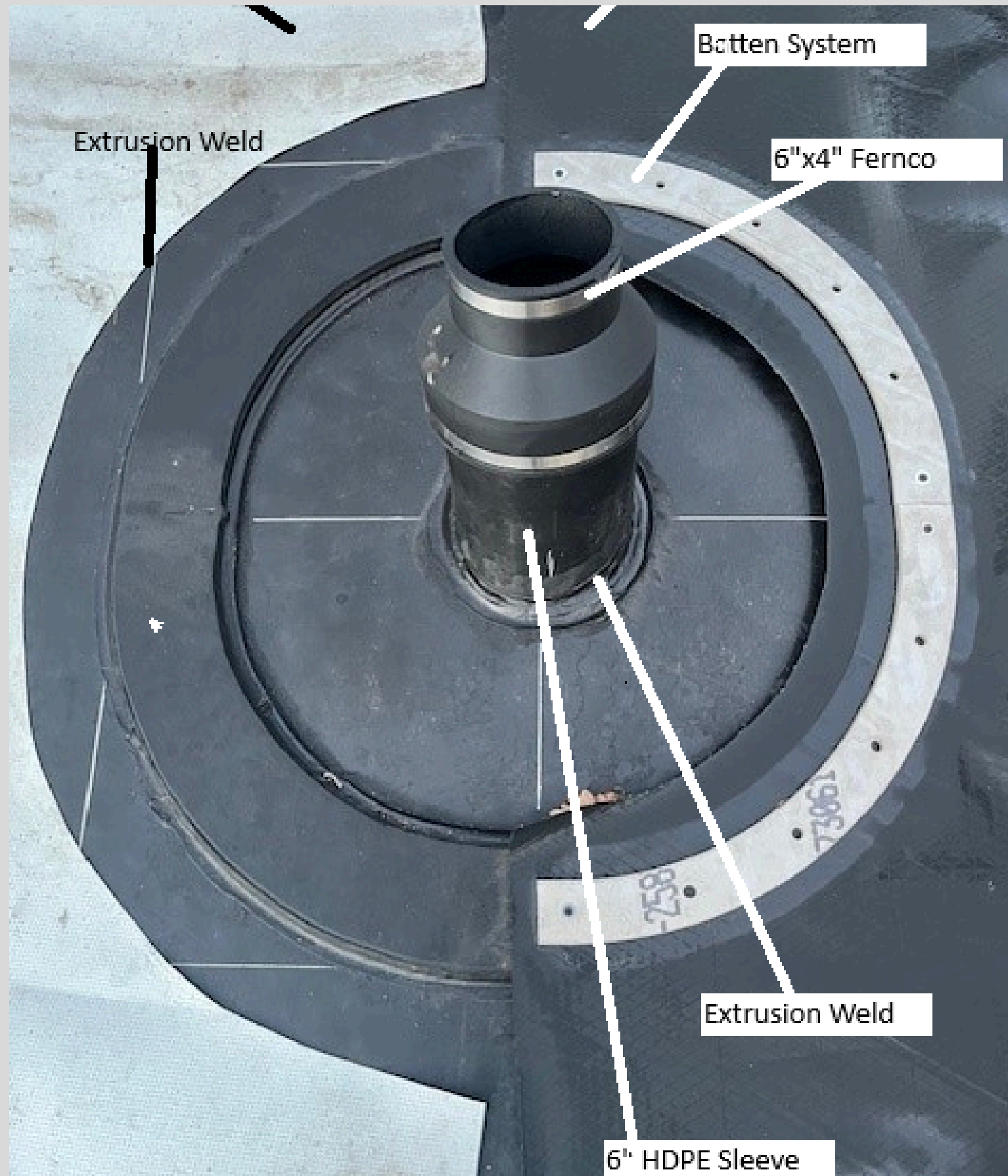



BEFORE AND AFTER



EASY SEAL PRODUCT DATA, SPECIFICATIONS		
Easy Seal Base	AGRU 5mm Ultra Grip	52" X 52" Sizes (Nominal)
	ASTM D5119, D792, D6693, D4218, D5596, ISO 4624	
Batten Strip	2" X 1/4" Alumminum Batten Strip	3/8" Holes 4" O/C
	ASTM B221 6061 T6511 793876-7/1A	
Sheet Metal Screws	5/16x1" Hex/HWH for Batten System	Steel
Butyl Tape	2" X 1/8" Butyl Rubber and Bitumen	Color Black
Seal Sleeve	HDPE DR17, IPS, PIPE ASTM D3350	Sizes (Nominal)
Fernco	ASTM D5926, C1173, and CSA B602	Sizes (Nominal)
Anchor	Mainstream Engineering Corp. ASCE 7-16	22"
Extrusion Welding	DVS 2227-1 Standard	
Extrusion Testing	BD10 - 10AST Spark testing / Factory only	Electro Products Inc.

PRICING!!

WHEN CONSIDERING THE EMISSIONS SEAL!

- **DURABILITY, CONSTRUCTED OUT OF HEAVY DUTY HDPE**
- **LONGEVITY, SHOULD LAST THE LIFE OF THE LANDFILL**
- **ADAPTABILITY, CAN BE REUSED AT OTHER WELLS AND TEMP TO CLOSURE APPLICATIONS**
- **ADJUSTABILITY, CAN BE FABRICATED TO ANY SLOPE ANGLE OR SIZE, ONE SIZE DOES NOT FIT ALL, MAINTAINS SEAL DURING SETTLEMENT**
- **PROFITABILITY, REVENUE THAT COULD BE SAVED BY UNNECESSARY REPAIRS AND EXCESS LABOR COSTS OF REMONITORING FOR EMISSIONS CONTROL AT LANDFILL PENETRATIONS. REDRILLING WELLS, FINES INCURED BY EXCESS EXCEEDANCES, COMPLIANCE ISSUES**
- **ASTHETICS, KEEP YOUR LANDFILL LOOKING CLEAN AND PROFESSIONAL**

HORIZONTAL WELL, TEMP SLOPE W/ BATTEN SYSTEM

SYSTEM SIDE, TEMP SLOPE W/ BATTEN SYSTEM

VERTICAL WELL, TEMP SLOPE W/ BATTEN SYSTEM

HORIZONTAL WELL CLOSURE / SLOPE, NO BATTEN SYSTEM

SYSTEM SIDE CLOSURE / SLOPE, NO BATTEN SYSTEM

VERTICAL WELL CLOSURE / SLOPE, NO BATTEN SYSTEM

PRICING CAN VARY DUE TO:

- **APPLICATION AND PENETRATION SIZE**
- **DECK, SLOPE APPLICATION, SPECIAL APPLICATION OR FABRICATION CHALLENGES**
- **MULTIPLE PENETRATIONS AT A SINGLE LOCATION E.G. WELL-AIR-LEACHATE-SYSTEM SIDE PRESSURE IN A BUNDLE. STILL IN DESIGN PHASE.**
- **QUANTITY ORDERED**

FOR ORDER FORM AND PRICING REACH OUT TO, [KENT@KI-POLY.COM](mailto:kent@ki-poly.com) 541-973-6967

OTHER PRODUCTS!!

UNDERGROUND REMOTE WELLHEAD BOX

PATENT PENDING



PLEASE SEND AN EMAIL OR GIVE US A CALL FOR INFORMATION ON THESE PRODUCTS

AND MORE FROM,

KI-POLY FUSION LLC.

WE THINK OUTSIDE THE BOX!!!

KENT IMEL

KENT@KI-POLY.COM

541-973-6967